

Holy Taxiarchai & Saint Haralambos Greek Orthodox Church

Stage Discussion
May 15, 2018



New Building – 1st Floor

Kitchen Area

Entrance from
Parking Lot

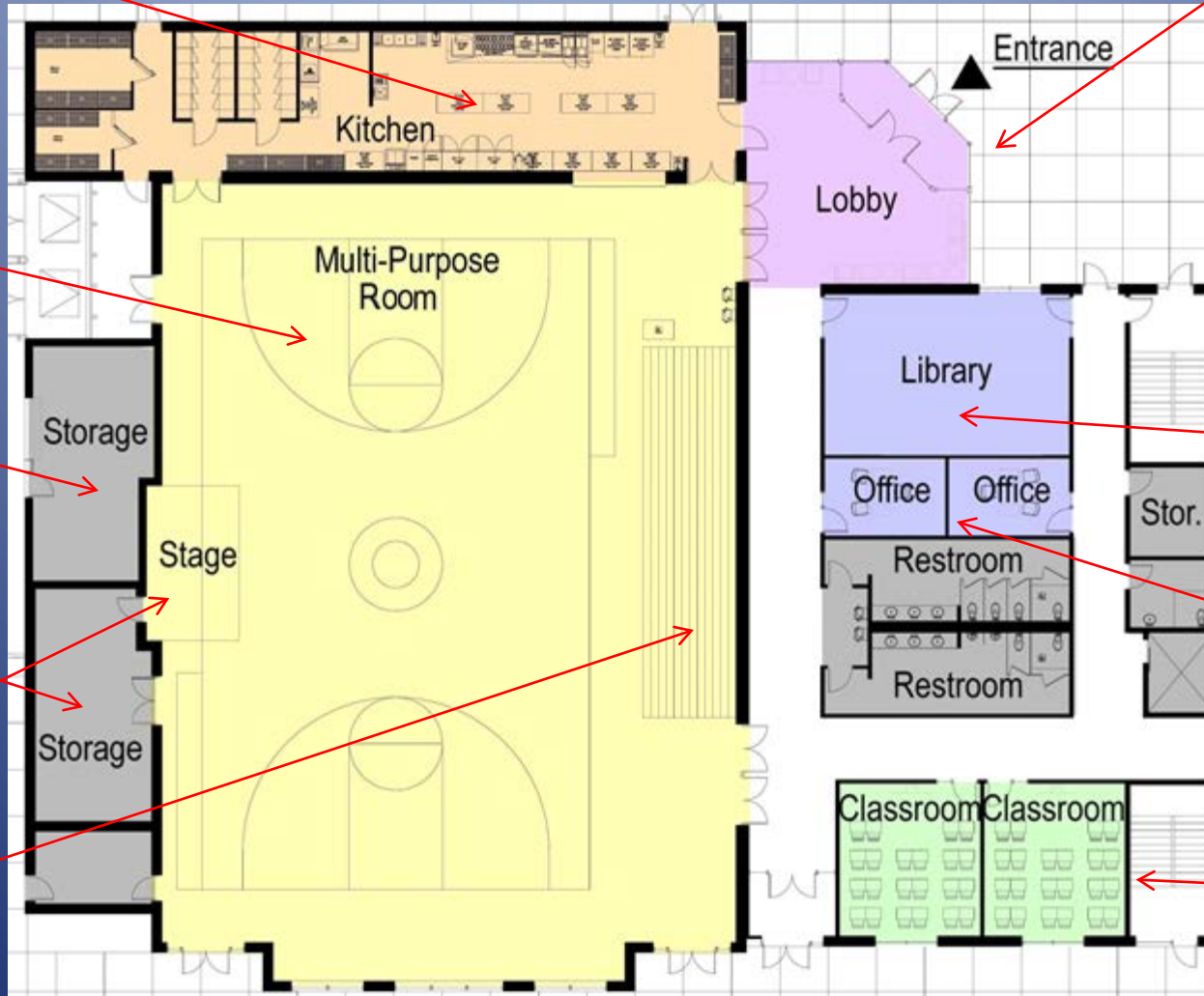

Multipurpose Room
Fellowship Hall /
Auditorium /
Gymnasium /

Depending on
constructions costs
and available funds,
this section of the
building will be
available but
unfinished.

External Storage (for
Food Festival and
other outdoor items)

AS FUNDS PERMIT:
Library / Meeting
Room

Internal Storage (for
tables, chairs, etc.)

AS FUNDS PERMIT:
Storage / Offices
For Philoptochos
and
PTAs

Portable Stage

AS FUNDS PERMIT:
Two Additional
Classrooms

Portable Bleachers

Factors Considered

- The following factors were considered in the initial decision to proceed with a non-permanent stage.
 - **Functionality - How will the stage be used?**
 - School performances (Greek schools & Sunday school)
 - Dance performances
 - Other presentations and fundraisers
 - **Usage – How often will the stage be used?**
 - School & Dance performances – Less than 20 per year, usually occurring around the same time.
 - Presentations / speeches – Less than 5 per year
 - **Cost – What would it cost to provide space for a stage and to build a stage?**

Alternative #1 – Permanent Stage

- A permanent stage built within the Multipurpose building.
- Advantages:
 - Sturdy construction
 - Looks professional
 - Always available
 - Meets all functionality requirements
- Disadvantages:
 - Takes up a lot of space
 - Cost of \$200,000 to \$300,000
 - Expensive to build (\$50,000+)
 - Fixed location and size
 - Potential liability



Alternative #2 – Portable Stage

- A portable stage which could be placed in storage and assembled when needed.
- Advantages:
 - Unlimited size
 - Sturdy construction
 - Fits within any space
 - Flexible usage
 - Reasonably priced (< \$50,000)
 - Very common in schools and churches
 - Meets all functionality requirements
- Disadvantages:
 - Requires setup time



Alternative #3 – Retractable Stage

- A fixed stage which is lowered into position when needed.
- Advantages:
 - Maximum size of 16' x 40'
 - Sturdy construction
 - Minimal setup time
 - Takes up little space
 - Meets all functionality requirements
- Disadvantages:
 - Expensive (\$175,000)
 - Fixed location / size
 - 24" height
 - Requires stage filler



Alternative #4 – Expanding Stage

- A portable stage with an expanding curtain system around it.
- Advantages:
 - Sturdy construction
 - Takes up less space (5' deep)
 - Meets all functionality requirements
- Disadvantages:
 - Stage requires setup time
 - Moderately Expensive (up to \$115,000 with lighting and curtains)
 - Maximum size of 16' x 32'
 - Fixed location



Summary of Options

	Permanent Stage	Portable Stage	Retractable Stage	Expanding Stage
Stage Dimensions (d x w)	20' x 40'	20' x 40' (up to any size we want)	16' x 40' (maximum)	16' x 32' (maximum)
Stage Height	Fixed at 42"	Height adjustable from 24" to 36"	Fixed at 24"	Height adjustable from 24" to 36"
Placement	Fixed on east or west side of multi-purpose room	Could be placed anywhere.	Fixed on north side of multi-purpose room.	Fixed on north side or west multi-purpose room.
Impact to structure	Would require the Multipurpose Building to be increased by 15' to 20' in length.	No impact to the planned structure.	No impact to the planned structure.	No impact to the planned structure.
Impact to parking	12 to 20 parking spaces will be lost	No impact to the parking lot.	No impact to the parking lot.	No impact to the parking lot.
Approximate Cost	\$250,000 to \$350,000 depending on size	Up to \$50,000	\$175,000	\$95,000 to 115,000 for stage system plus curtains and lighting
Notes	<ul style="list-style-type: none"> • Lighting and curtains could be added. 	<ul style="list-style-type: none"> • Stored in the internal storage room. • Components can be moved and set up by one individual. • If stage width is limited to 32', lighting and curtains could be added. 	<ul style="list-style-type: none"> • The future installation of a retractable stage is included within the current plan. • If stage width is limited to 32', lighting and curtains could be added. 	<ul style="list-style-type: none"> • Could potentially be placed along the west side but with a maximum 32' span, it would not fit well within the existing building face.



Original Stage Recommendation

- Based on Functionality, Usage and Cost, the Phase III Committee recommended against installing a permanent stage.
 - This decision was backed by the Parish priests.
 - This decision was communicated to the school Directors.
 - The full Phase III design, which included a retractable stage, was presented to the General Assembly in November 2015 and approved with minimal objection.

Frequently Asked Questions

- **Why can't the stage replace the storage area on the north side of the building?**
 - As designed, the storage structure is only deep enough to hold a 15' stage. The structure cannot be expanded to the north.
 - The height of the storage structure would have to be raised by at least 6.5'.
 - Large steel beams would have to be installed to support the north wall above the stage.
 - All storage in that building would be lost. This affects tables, chairs, and large equipment which cannot be stored in the basement.
- **Where else in the structure can a permanent stage be placed?**
 - A detailed document reviewing all potential locations was assembled. Copies are available tonight if you would like to read through that.
 - Within the current design, there is no location for a permanent stage which does not drastically affect cost and/or functionality of the remaining space.

Frequently Asked Questions

- **Why can't we change the design?**
 - Funds for the Phase III project are limited.
 - In 2017, a reasonable path to move forward with the project was identified.
 - The original floorplan, which was approved by the General Assembly, was not modified.
 - Construction was broken into phases which would allow us to build as funds were available.
 - All resources have been moving along that path.
 - Architectural drawings were submitted in March for permits that would allow construction to start after the Food Festival.
 - All remaining drawings are almost completed.
- **Even if the stage costs \$250,000, isn't it worth doing?**
 - Once again, funds for the Phase III project are limited.
 - Available funds could be better used toward classroom buildout and renovation.
 - Less expensive and equally functional alternatives are available.

Discussion / Questions